

**100,000 SF Block**  
**Parking: 10/1,000 SF**



## 5000 Hadley Road

South Plainfield, New Jersey

### PROPERTY FEATURES

- 226,000 SF 2 story with Atrium Lobby
- Owner Occupied
- +17 Acre Site
- 10 cars per 1,000 SF Parking
- Large Floor Plate + 100,000 SF
- Ideal for High Density User

1315 Stelton Road  
Piscataway, NJ 08854  
732 985 3000

[naidb.com](http://naidb.com)

### Space Available

FLOOR	RENTABLE SQ. FT.	
Partial 1st *Former School Space	33,700 RSF	} Can combine to 55,700 Rsf
Partial 1st	22,000 RSF	
Partial 1st	9,500 RSF	
Partial 2nd	+/-95,000 RSF	(can divide)

*For Further Information, Please Contact Exclusive Broker:*

**ROBERT A. DINNER**

*Executive Vice President*

732 839 6994 | [rdinner@naidb.com](mailto:rdinner@naidb.com)

**CHRISTOPHER GALIANO, SIOR**

*Managing Director*

732 985 3009 | [cgaliano@naidb.com](mailto:cgaliano@naidb.com)

# 5000 HADLEY ROAD

## Partial 1<sup>st</sup> Floor

### FEATURES

- 33,700 Rsf Former School Space
  - ✓ Existing Build-Out
  - ✓ 2 Building Entrances
  - ✓ Private Bathrooms
- 22,000 Rsf Available Unit
- 9,500 Rsf Available Unit
- 10 Per 1,000 SF Car Parking
- NJ Transit Bus Service at Building

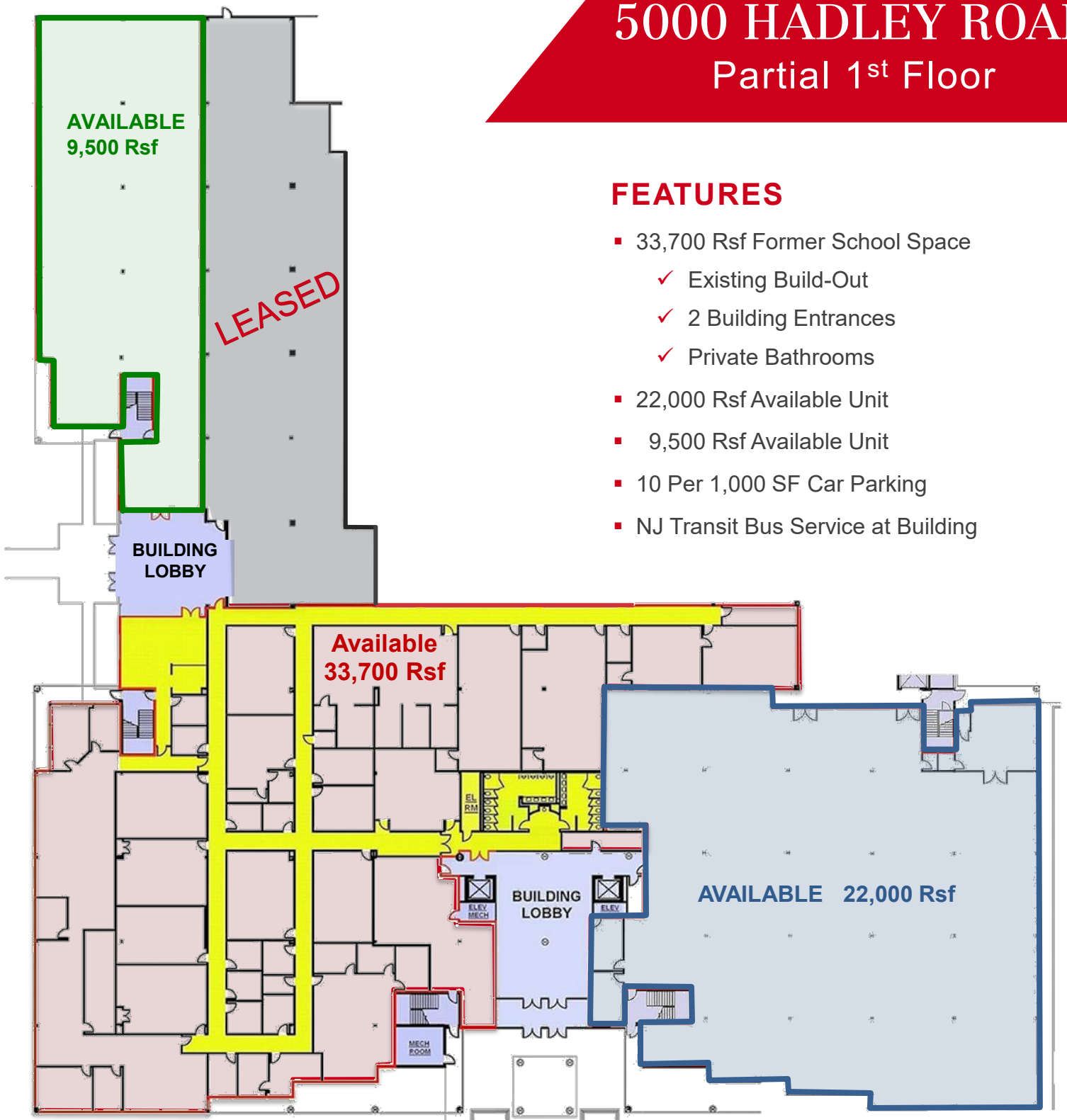

### Former Career Training Trade-School

Existing 33,700 Rsf Built Out + 22,000 Rsf = 55,700 Rsf  
+ Additional 9,500 Rsf and 95,000 Rsf

## 2<sup>nd</sup> Floor

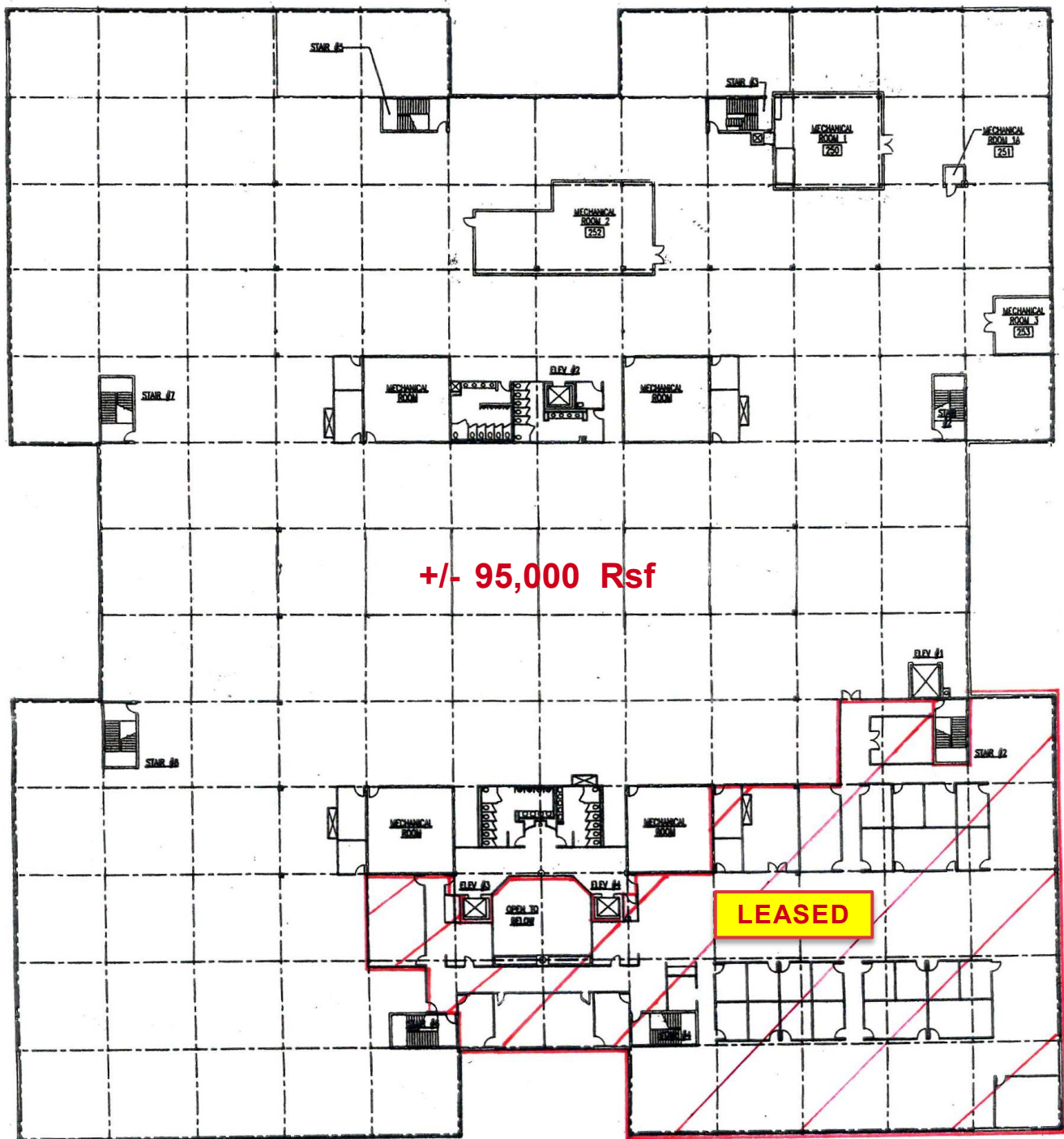

## 2nd FLOOR

Available +/- 95,000 Rsf (Will Divide)



# OFFICE SPACE For Lease



## ABOUT THE LOCATION

- Located at Intersection of Stelton Road/Centennial Avenue in Piscataway and two (2) I-287 Exits #4 (Durham Road) and #5 (Stelton Road)
- Surrounded by shopping centers, restaurants, banks, hotels and public transportation
- Near New Jersey Turnpike, Garden State Parkway, US Routes 1 & 9, Routes 27, 28 and 440 to Outerbridge Crossing
- 20 minutes to Newark International Airport



*For Further Information, Please Contact Exclusive Broker:*

**ROBERT A. DINNER**

*Executive Vice President*

732 839 6994 | [rdinner@naidb.com](mailto:rdinner@naidb.com)

**CHRISTOPHER GALIANO, SIOR**

*Managing Director*

732 985 3009 | [cgaliano@naidb.com](mailto:cgaliano@naidb.com)

1315 Stelton Road  
Piscataway, NJ 08854  
732 985 3000

[naidb.com](http://naidb.com)